

SURFACE BOX REF.128
6 KG



PLACE OF INSTALLATION :

Pavement and roads

MATERIAL & COATING :

Spheroidal Cast Iron GJS 500-7.
Water Based Black Paint.

RESISTANCE :

400 kN

OPTION :

Heavy lids : 1,5kg or 3kg.

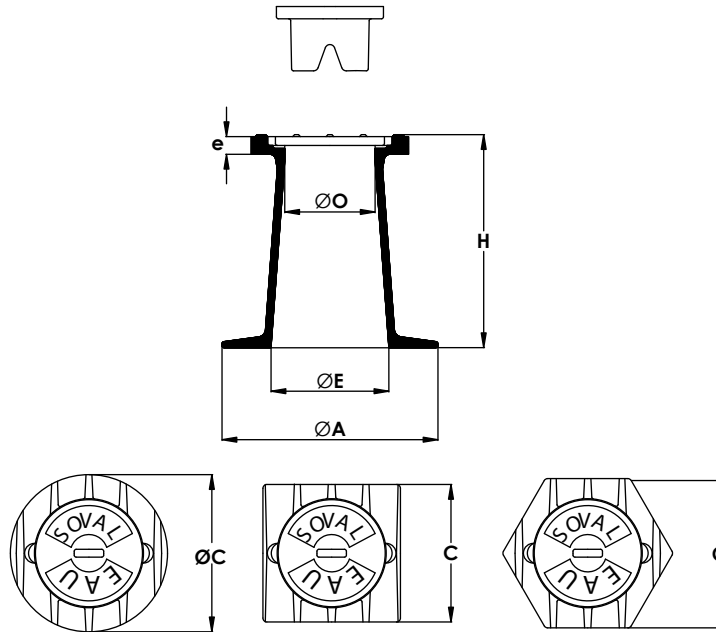

Reference	Description	C	O	E	H	A	e	Weight	
								lid	total
								mm	
								Kg	
6892	Round	160	92	120	215	200	10	1,2	6,0
6890	Square	140	92	120	215	200	10	1,2	6,0
6891	Hexagonal	152	92	120	215	200	10	1,2	6,0

All dimensions, weights and norms are given for information only. SOVAL reserves the right to modify the specifications of products given in the present document.